

TRG 350

AIR-COOLED MIG GUN

Replacement Suitable for Tregaskiss®

RATING	GUN ORDERING PART NUMBER	POWER PIN Direct Connect
350 Amp CO2 @ 80% Duty Cycle 250 Amp Mixed Gas @ 80% Duty Cycle Wire Capacity: 0.030" (0.8mm) - 0.062" (1.6mm)	R30xx-35 RB30xx-35 RE30xx-35 RLN30xx-35 RLF30xx-35 RLPM30xx-35 RM30xx-35 RPA30xx-35	Tweco® #4 Bernard® Euro Lincoln® "LN" Lincoln® "LF"/Powerfeed 10 Lincoln® Power MIG™ Miller® Panasonic®
xx = Standard lengths of 10, 12, 15, 20, and 25 ft. Custom lengths also available.		

#	Part Number	Description
1.	R401-4-38 R401-4-50 R401-4-62 R401-4-75 R401-8-62 R401-42-50 R401-48-50	Nozzle, 3/8", Flush Tip Nozzle, 1/2", 1/8" Tip Recess Nozzle, 5/8", 1/8" Tip Recess Nozzle, 3/4", 1/8" Tip Recess Nozzle, 5/8", 1/8" Tip Stickout, Short Arc Nozzle, 1/2", Bottleneck, 1/8" Tip Recess Nozzle, 1/2", Bottleneck, 1/8" Tip Stickout
	R401-5-50 R401-5-62 R401-5-75	Nozzle, H.D., 1/2", 1/4" Tip Recess Nozzle, H.D., 5/8", 1/4" Tip Recess Nozzle, H.D., 3/4", 1/4" Tip Recess
	R401-6-50 R401-6-62 R401-6-75	Nozzle, H.D., 1/2", 1/8" Tip Recess Nozzle, H.D., 5/8", 1/8" Tip Recess Nozzle, H.D., 3/4", 1/8" Tip Recess
	R401-7-62 R401-7-75 R401-7-87	Nozzle, H.D., 5/8", 1/4" Tip Recess, Brass Nozzle, H.D., 3/4", 1/4" Tip Recess, Brass Nozzle, H.D., 7/8", 1/4" Tip Recess, Brass
2.	CM "Taper-LOCK" Contact Tips 155-1-030 155-1-035 155-1-040 155-1-045 155-1-364 155-1-052 155-1-062	H.D. Contact Tip, .030" (0.8mm) H.D. Contact Tip, .035" (0.9mm) H.D. Contact Tip, .040" (1.0mm) H.D. Contact Tip, .045" (1.2mm) H.D. Contact Tip, 3/64" (1.2mm) H.D. Contact Tip, .052" (1.4mm) H.D. Contact Tip, .062" (1.6mm)
3.	155-2-030 155-2-035 155-2-040 155-2-045 155-2-364 155-2-052 155-2-062	H.D. Tapered Contact Tip, .030" (0.8mm) H.D. Tapered Contact Tip, .035" (0.9mm) H.D. Tapered Contact Tip, .040" (1.0mm) H.D. Tapered Contact Tip, .045" (1.2mm) H.D. Tapered Contact Tip, 3/64" (1.2mm) H.D. Tapered Contact Tip, .052" (1.4mm) H.D. Tapered Contact Tip, .062" (1.6mm)
4.	154-R505	Diffuser H.D., for CM Taper-LOCK Tip
5.	154-1	Replacement Retaining Ring
6.	154-2	Replacement O-Ring
7.	154-R506	Diffuser, for CM Taper-LOCK Tip
8.	154-1	Replacement Retaining Ring
9.	154-2	Replacement O-Ring
10.	R402-11	Neck Insulator
11.	R305-45 R305-60	Neck w/ Body, 45° Neck w/ Body, 60°
12.	R407	Replacement Body
13.	R407-2	Body Screw

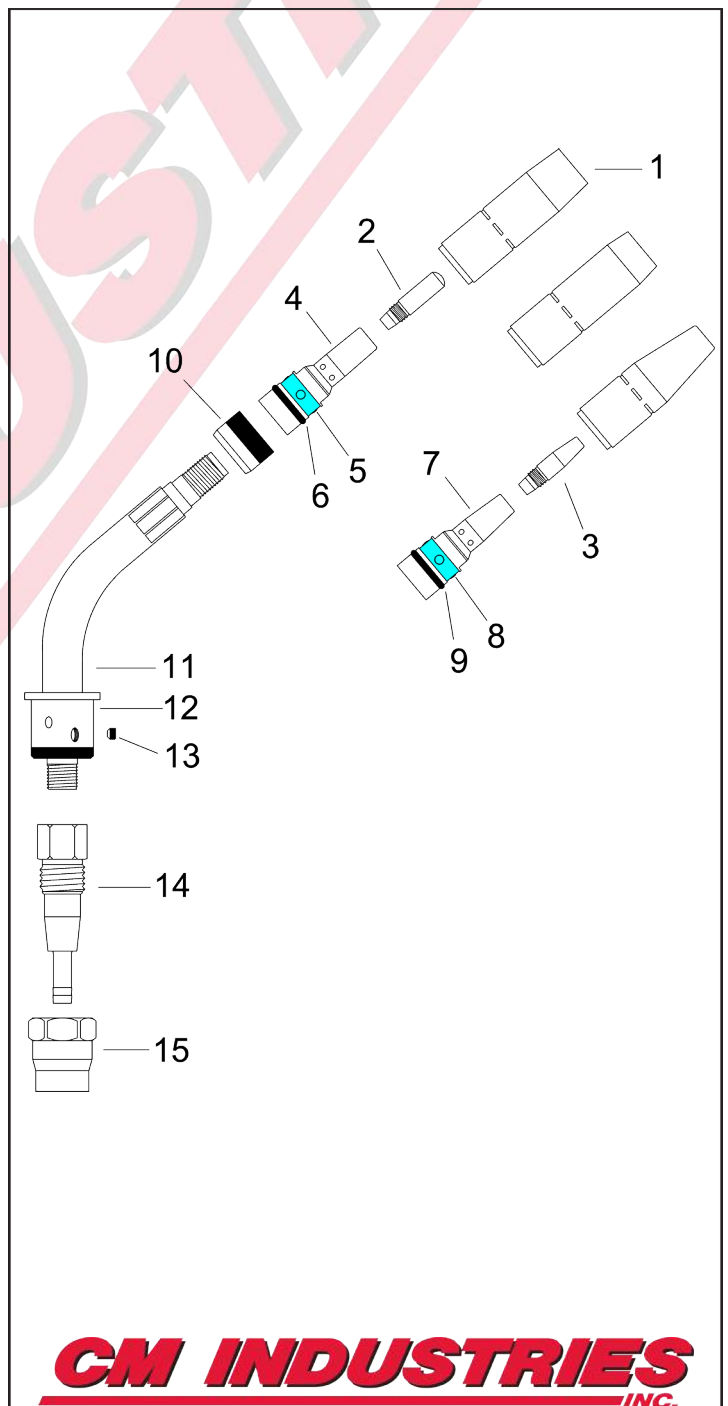

CM INDUSTRIES
INC.

#	Part Number	Description
14.	R408	Connector Cone
15.	R409	Cone Nut
16.	R413-5	Inner Tube Clamp
17.	R412-1	Switch Lead Connector
18.	R413-1	Outer Jacket Clamp
19.	R411-3	Mounting Screw
20.	R411-2	Switch Housing
21.	R411-1	Switch
22.	R410	Handle, Front
23.	R413-2	Spring Guard, Front
24.	R313-10CM	Unicable Assembly, 10'
	R313-12CM	Unicable Assembly, 12'
	R313-15CM	Unicable Assembly, 15'
	R313-20CM	Unicable Assembly, 20'
	R313-25CM	Unicable Assembly, 25'
25.	B2520041-S	Strain Relief Spring
26.	B2520066	Strain Relief Kit
27.	R414-400CM	Power Pin Block
28.	R214	Power Pin, Tweco
29.	R414-1	O-Ring
30.	C44C	Liner Set Screw
31.	R214-1	Power Pin, Miller
32.	R414-11-2	O-Ring, Miller
33.	R214-116	Guide Cap, Miller .035"-1/16" Wire
34.	R214-2	Power Pin, Lincoln "LN"
35.	401-00-001	Adaptor Nut
36.	285-03-002	Male Pin w/ Lead
37.	R425-10CM	Power Pin, Euro
38.	285-00-002	O-Ring, Euro
39.	300-05-001	Electrical Plug, Miller
40.	300-05-002	Electrical Plug, Lincoln
41.	R415-23-15	Liner Assembly, .023", 15'
	R415-30-15	Liner Assembly, .030", 15'
	R415-35-15	Liner Assembly .035"-.045", 15'
	R415-116-15	Liner Assembly .045"-1/16", 15'
	R415-35-2	Liner Assembly .035"-3/64", 15' Aluminum
	R415-116-2	Liner Assembly 3/64"-1/16", 15' Aluminum
	R415-35-0	Teflon Liner Assy., .035"-3/64", 15' Aluminum
	R415-116-0	Teflon Liner Assy., 3/64"-1/16", 15' Aluminum
	R415-35-25	Liner Assembly .035"-.045", 25'
	R415-116-25	Liner Assembly .045"-1/16", 25'

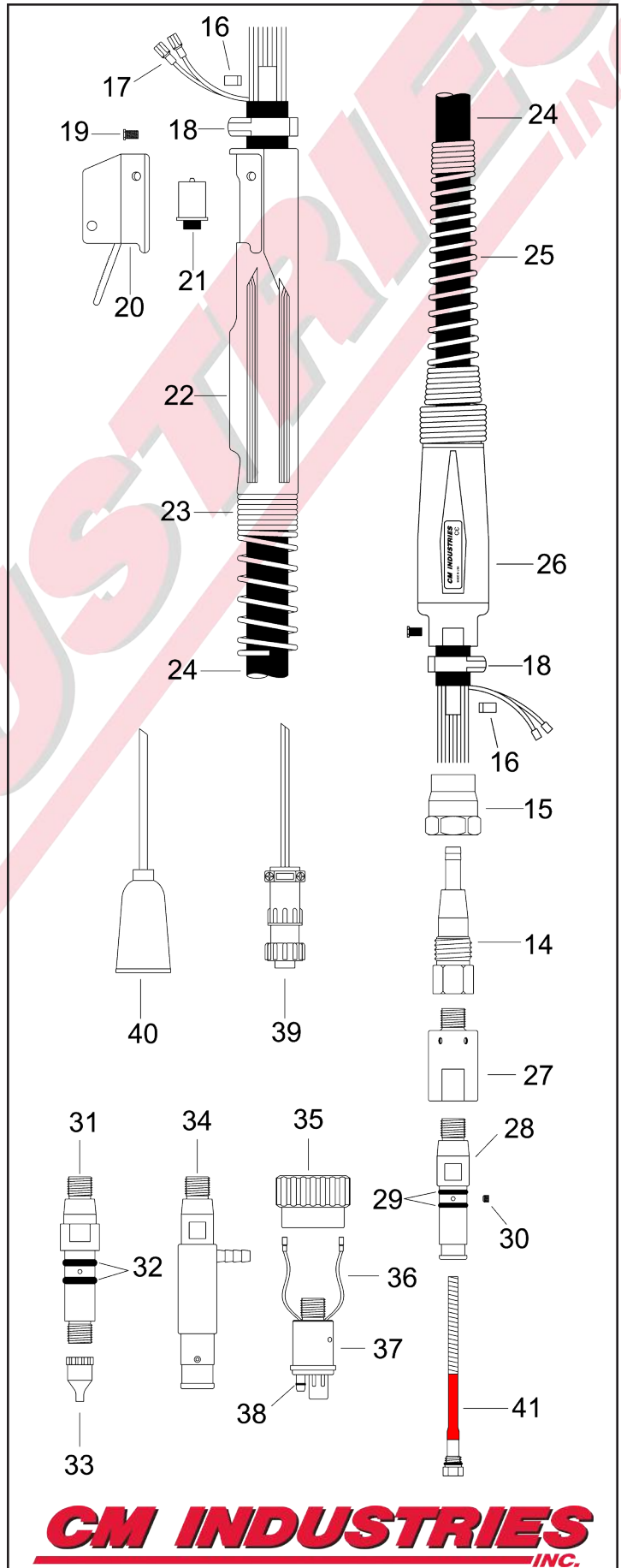

WARNING!

Please Read All Safety Instructions



WARNING

- Read and follow the manufacturer's instructions, employer's safety practices, and Material Safety Data Sheets (MSDSs).
- Only qualified personnel should install, use, or service this material and/or equipment.



ELECTRIC SHOCK can kill.

- Always wear dry installing gloves.
- Do not touch live electrical parts.
- Always disconnect power source before hooking up or changing electrodes, nozzles and other parts.



WELDING SPARKS can cause fire or explosion

- Do not weld near flammable material.
- Do not weld on closed containers.
- Remove combustibles from the work area and/or provide a fire watch.
- Avoid oily or greasy clothing as a spark may ignite them.



LOUD NOISE can damage hearing.

- Always wear protective hearing devices to ensure protection when noise levels exceed OSHA standards.



ARC RAYS can injure eyes and burn skin.

- Always wear correct eye, ear, and body protection.
- Always wear a welding helmet with the proper grade filter lens. Protect yourself and others from spatter arc rays by using protective screens, barriers and welding curtains.
- Always wear protective gloves and clothing to cover exposed skin. This will aid in the prevention of arc and spatter burns.



FUMES AND GASES can be hazardous to your health.

- Keep your head out of the fumes.
- Use enough ventilation or exhaust at the arc to keep fumes and gases from your breathing zone, and general area.
- Fumes from cutting and welding can deplete air quality, causing injury or death. Always wear an air supplied respirator in confined areas, or if breathing air is not safe.

Read America Nation Standard Z49.1, "Safety in Welding, Cutting, and Allied Processes," available from America Welding Society, 550 N.W. LeJeune Rd., Miami, FL 33126;

OSHA Safety and health standards, available from U.S. Government Printing Office, Washington DC 20402

CM INDUSTRIES *INC.*

505 OAKWOOD ROAD LAKE ZURICH, IL 60047

PH: 847-550-0033 FX: 847-550-0444

www.cmindustries.com