

# BND 300-G

## AIR-COOLED MIG GUN

Replacement Suitable for Bernard®

RATING	GUN ORDERING PART NUMBER		POWER PIN Direct Connect
	BOTTOM TRIGGER	TOP TRIGGER	
300 AMP CO2 @ 100% Duty Cycle	B52xxA	B52xxA-TT	Bernard®
250 Amp Mixed Gas @ 100% Duty Cycle	B52xxAE	B52xxAE-TT	Euro
	B52xxAL	B52xxAL-TT	Lincoln® "LN"
	B52xxAM	B52xxAM-TT	Miller®
	B52xxAT	B52xxAT-TT	Tweco®
Wire Capacity: 0.023" (0.6mm) - 1/16" (1.6mm)	xx = Standard lengths of 10, 12, 15, 20, and 25 ft. Custom lengths also available.		

#	Part Number	Description
1.	B4391 B4393	Nozzle - Brass 5/8" I.D. Nozzle - Copper 5/8" I.D.
2.	B4392 B4394	Nozzle - Brass 1/2" I.D. Nozzle - Copper 1/2" I.D.
3.	B4295	Nozzle - Brass Tapered, Long 11/32" I.D.
4.	B7497 B7488 B7489 B7496 B7490 B7498 B7491	Contact Tip, .023" (0.6mm) Contact Tip, .030" (0.8mm) Contact Tip, .035" (0.9mm) Contact Tip, .040" (1.0mm) Contact Tip, .045" (1.2mm) Contact Tip, .052" (1.4mm) Contact Tip, 1/16" (1.6mm)
5.	B4285 B4281 B4299 B4282 B4283	Contact Tip, Tapered, .030" (0.8mm) Contact Tip, Tapered, .035" (0.9mm) Contact Tip, Tapered, .040" (1.0mm) Contact Tip, Tapered, .045" (1.2mm) Contact Tip, Tapered, .052" (1.4mm)
5a.	GT030H GT035H GT040H GT045H GT364H GT052H GT062H	Contact Tip, H.D. Threaded, .030" (0.8mm) Contact Tip, H.D. Threaded, .035" (0.9mm) Contact Tip, H.D. Threaded, .040" (1.0mm) Contact Tip, H.D. Threaded, .045" (1.2mm) Contact Tip, H.D. Threaded, 3/64" (1.3mm) Contact Tip, H.D. Threaded, .052" (1.4mm) Contact Tip, H.D. Threaded, 1/16" (1.6mm)
5b.	GD514 GD518 GD510	Diffuser, 1/4" Recess, for GT Tips Diffuser, 1/8" Recess, for GT Tips Diffuser, Flush, for GT Tips
6.	B7392	Head Assembly
7.	B5253	Silicone Cap
8.	B5269	Body Tube Assembly
9.	B5218	Spacer Kit
9a.	B608	Handle Screw
10.	B4617	Insulator Spacer
11.	B260	Handle Kit
12.	B422	Trigger Switch Assembly
13.	B418	Trigger Switch Screw
14.	B5213	End Fitting
15.	B4305	Cone Nut
16.	B4991	Clamp, Conduit
17.	B457	Trigger Terminal
18.	B7669	Clamp, Jacket

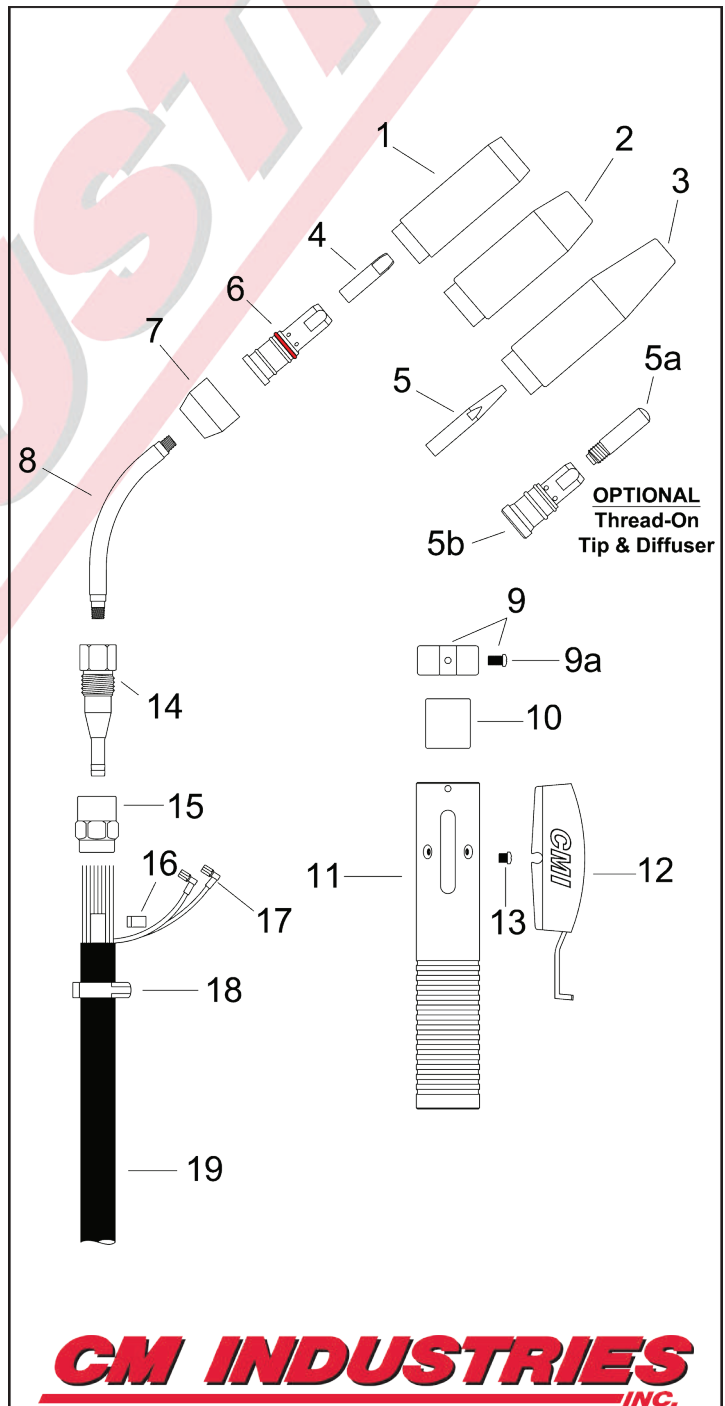

#	Part Number	Description
19.	B1060109	300A Cable Assembly, 10'
	B1060110	300A Cable Assembly, 12'
	B1060111	300A Cable Assembly, 15'
	B1060112	300A Cable Assembly, 20'
	B1060113	300A Cable Assembly, 25'
20.	B2520041-S	Strain Relief Spring
21.	B2520066	Strain Relief Kit
22.	B2280056	Screw
23.	BGN2021	Electrical Plug, Miller
24.	B4719	Electrical Plug, Lincoln
25.	B1010027R	Adaptor Block
26.	R214-1	Power Pin w/ O-Rings, Miller
27.	R214-116	Power Pin Tip, Miller .035" - 1/16"
28.	R414-11-2	O-Ring, Miller
29.	R214	Power Pin w/ O-Rings, Tweco 4
30.	R414-1	O-Ring, Tweco 4
31.	C44C	Set Screw
32.	B214-2	Power Pin, Lincoln "LN"
33.	B4816	Euro Connector Nut
34.	B5060CM	Euro Connector Plug
35.	B4421	O-Ring, Euro
36.	B2520041-S	Strain Relief Spring
37.	B1880074	Rigid Strain Relief Kit
38.	B4925	Locking Sleeve
39.	B4901	Quick Connect Body
40.	B4924	Lead Wire
41.	B4919	Gas Pin Assembly
42.	B4916	Wave Spring
43.	B4912	Snap Ring, Small
44.	B4911	Snap Ring, Large
45.	B2200140	Power Pin, Bernard EZ
	B1880259B	Bernard Quick Disconnect Kit (38-45)
46.	L1A-15	Liner Assembly, 15', .023"-.030"
	L2A-15	Liner Assembly, 15', .030"-.035"
	L3A-15	Liner Assembly, 15', .035"-.045"
	L4A-15	Liner Assembly, 15', .045"- 1/16"

Liners are also available in 25' lengths

