

TWC 160

AIR-COOLED MIG GUN

Replacement Suitable for Tweco®

RATING	GUN ORDERING PART NUMBER	POWER PIN Direct Connect
160 Amp CO2 @ 80% Duty Cycle 100 Amp Mixed Gas @ 80% Duty Cycle Wire Capacity: 0.023" (0.6mm) - 0.045" (1.2mm)	C35-xx CC35-xx CX35-xx CH35-xx CH1035-xx CSP35-xx CL35-xx CLPM35-xx CM35-xx CT35-xx	No Gun Plug Century® Euro Hobart® Hobart® / Miller® H10 Lincoln® SP150 & SP200 Linc.® SP100, 125, 135, 175 Lincoln® Power MIG™ Miller® Tweco®
	xx = Standard lengths of 10, 12, 15, 20, and 25 ft. Custom lengths also available.	

#	Part Number	Description	
1.	C21-50	Nozzle, 1/2" I.D., Std.	
	C21-50-F	Nozzle, 1/2" I.D. Flush	
	C21-62	Nozzle, 5/8" I.D.	
	C21-62-F	Nozzle, 5/8" I.D. Flush	
	C21-62-FAS	Spot Nozzle	
	C21-37	Nozzle, 3/8" I.D.	
	C21-37-F	Nozzle, 3/8" I.D. Flush	
	C21T-37	Nozzle Tapered, 3/8" I.D.	
	C21T-37-F	Nozzle Tapered, 3/8" I.D. Flush	
	2.	C11-23	Contact Tip, .023" 0.6mm
		C11-30	Contact Tip, .030" 0.8mm
C11-35		Contact Tip, .035" 0.9mm, Std.	
C11-40		Contact Tip, .040" 1.0mm	
C11-45		Contact Tip, .045" 1.2mm	
C11H-35		Contact Tip, H.D., .035" 0.9mm	
C11H-45		Contact Tip, H.D., .045" 1.2mm	
C11AH-364		Contact Tip, H.D., Aluminum, 3/64"	
C11T-23		Contact Tip, Tapered, .023" 0.6mm	
C11T-30		Contact Tip, Tapered, .030" 0.8mm	
C11T-35		Contact Tip, Tapered, .035" 0.9mm	
C11T-40		Contact Tip, Tapered, .040" 1.0mm	
C11T-45		Contact Tip, Tapered, .045" 1.2mm	
3.		C35-50	Gas Diffuser, Std.
4.		C35-60-45	Conductor Tube, 45°
	C35-60-60	Conductor Tube, 60°, Std.	
	C35-60-180	Conductor Tube, 180°	
(Includes Items 4-6)			
5.	C35-70	Conductor Tube Insulation	
6.	C35-60-N	Conductor Tube Nut	
7.	C35-80CM	Handle, TWC 160	
8.	170-14-100	Trigger Switch	
9.	C35K-TWC	Conductor Tube Adaptor, TWC 160	
10.	300-05-003	Trigger Wire Connector	
11.	C35-010CM	Power Cable, 10', TWC 160	
	C35-012CM	Power Cable, 12', TWC 160	
	C35-015CM	Power Cable, 15', TWC 160	

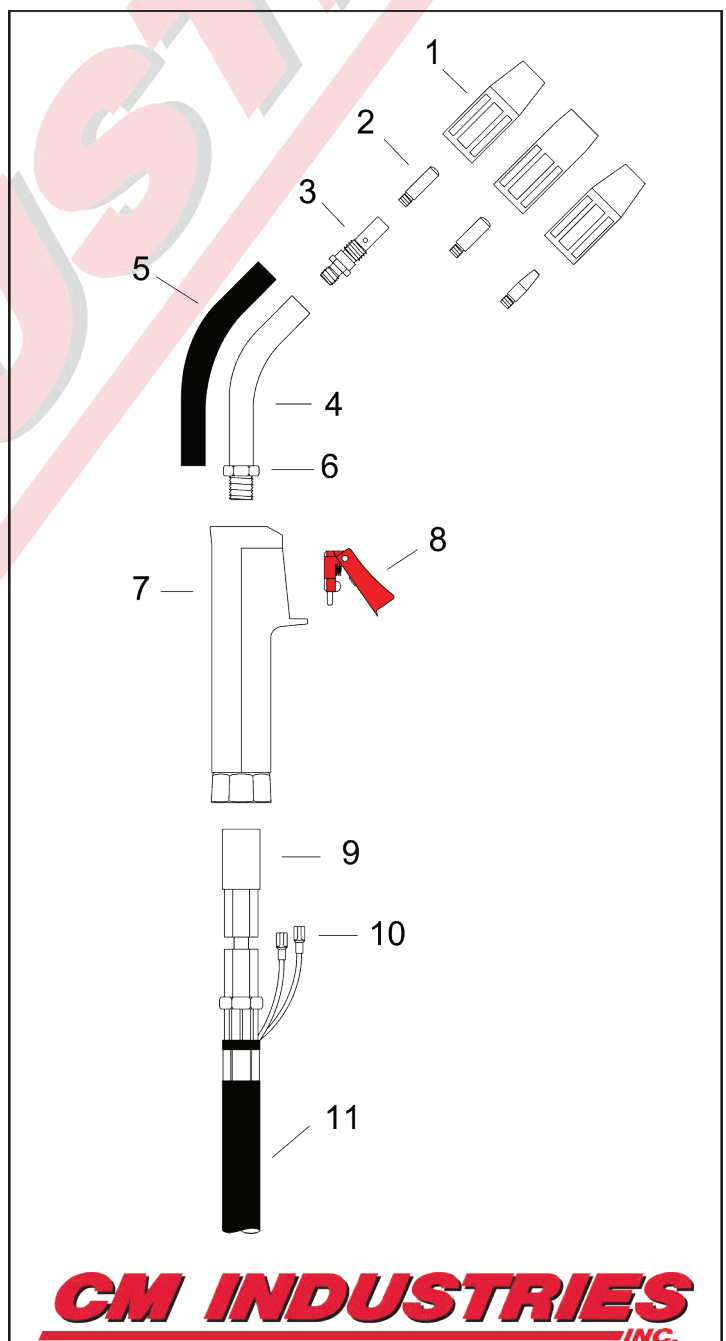

CM INDUSTRIES
INC.

#	Part Number	Description
12.	185-26-001	Cable Support Spring
13.	C35-230CM	Cable Support
14.	285-01-001	Adaptor Support Screw
15.	C35-170-4T	Gas Hose Nipple
16.	C35-170CM	Adaptor Block
17.	C35K-174C	Gun Plug, Tweco®
18.	C224	O-Ring
19.	CTAK-352-C1	Gun Plug, Century®
20.	CMAK-352	Gun Plug, Miller®
21.	C224M	O-Ring, Miller
22.	C174M-1N	Conduit Nut, Miller® Plug
23.	CTAK-352-L	Gun Plug, Lincoln® SP100 & SP175
24.	CTAK-352-H	Gun Plug, Hobart® Handler®
25.	CTLAK-352	Gun Plug, Lincoln® LN, SP150 & SP200
26.	CTAK-352-L	Gun Plug, Lincoln® Power MIG™
27.	C174X-2	Adaptor Nut
28.	C174EX-1	Euro-Kwik Adaptor Assembly
29.	C174EX-1G	O-Ring, Euro
30.	C174EX-1C	Conduit Nut, Euro Kwik
31.	300-05-001	Electrical Plug, Miller®/Lincoln® Power MIG™
32.	300-05-002	Electrical Plug, Lincoln® LN, SP150 & SP200
33.	300-05-005	Electrical Plug, Century®
34.	C23-40-15	Liner Assembly, 15' .023"
	C35-40-15	Liner Assembly, 15' .030"-.035", Std.
	C45-40-15	Liner Assembly, 15' .040"-.045"
	C35TF-40-10	Teflon Liner Assembly, 10' .030"-.035"
	C35TF-40-15	Teflon Liner Assembly, 15' .030"-.035"
	C45TF-40-10	Teflon Liner Assembly, 10' .040"-3/64"
	C45TF-40-15	Teflon Liner Assembly, 15' .040"-3/64"
35.	C23-40-15ST	Liner Assembly w/ Stickout, 15' .023"
	C35-40-15ST	Liner Assembly w/ Stickout, 15' .030"-.035"
	C45-40-15ST	Liner Assembly w/ Stickout, 15' .040"-.045"

