

# TRG 550

## AIR-COOLED MIG GUN

Replacement Suitable for Tregaskiss®

| RATING   | GUN ORDERING PART NUMBER  | POWER PIN Direct Connect   |
|--|---|--|
| <b>550 Amp CO2</b><br><b>@ 80% Duty Cycle</b><br><br><b>425 Amp Mixed Gas</b><br><b>@ 80% Duty Cycle</b><br><br><b>Wire Capacity:</b><br><b>0.035" (0.9mm) -</b><br><b>3/32" (2.4mm)</b> | R50xx-52<br>RB50xx-52<br>RE50xx-52<br>RLN50xx-52<br>RLF50xx-52<br>RM50xx-52<br>RPA50xx-52<br>RTW50xx-52 | Tweco® #4<br>Bernard®<br>Euro<br>Lincoln® "LN"<br>Lincoln® "LF"/Powerfeed 10<br>Miller®<br>Panasonic®<br>Tweco® #5 |
| xx = Standard lengths of 10, 12, 15, 20, and 25 ft. Custom lengths also available.   |   |  |

| #   | Part Number                  | Description                                 |
|-----|------------------------------|---|
| 1.  | R401-4-38                    | Nozzle, 3/8", Flush Tip                     |
|     | R401-4-50                    | Nozzle, 1/2", 1/8" Tip Recess               |
|     | R401-4-62                    | Nozzle, 5/8", 1/8" Tip Recess               |
|     | R401-4-75                    | Nozzle, 3/4", 1/8" Tip Recess               |
|     | R401-8-62                    | Nozzle, 5/8", 1/8" Tip Stickout, Short Arc  |
|     | R401-42-50                   | Nozzle, 1/2", Bottleneck, 1/8" Tip Recess   |
|     | R401-48-50                   | Nozzle, 1/2", Bottleneck, 1/8" Tip Stickout |
|     | R401-5-50                    | Nozzle, H.D., 1/2", 1/4" Tip Recess         |
|     | R401-5-62                    | Nozzle, H.D., 5/8", 1/4" Tip Recess         |
|     | R401-5-75                    | Nozzle, H.D., 3/4", 1/4" Tip Recess         |
|     | R401-6-50                    | Nozzle, H.D., 1/2", 1/8" Tip Recess         |
|     | R401-6-62                    | Nozzle, H.D., 5/8", 1/8" Tip Recess         |
|     | R401-6-75                    | Nozzle, H.D., 3/4", 1/8" Tip Recess         |
|     | R401-7-62                    | Nozzle, H.D., 5/8", 1/4" Tip Recess, Brass  |
|     | R401-7-75                    | Nozzle, H.D., 3/4", 1/4" Tip Recess, Brass  |
|     | R401-7-87                    | Nozzle, H.D., 7/8", 1/4" Tip Recess, Brass  |
| 2.  | CM "Taper-LOCK" Contact Tips |   |
|     | 155-1-030                    | H.D. Contact Tip, .030" (0.8mm)             |
|     | 155-1-035                    | H.D. Contact Tip, .035" (0.9mm)             |
|     | 155-1-040                    | H.D. Contact Tip, .040" (1.0mm)             |
|     | 155-1-045                    | H.D. Contact Tip, .045" (1.2mm)             |
|     | 155-1-364                    | H.D. Contact Tip, 3/64" (1.2mm)             |
|     | 155-1-052                    | H.D. Contact Tip, .052" (1.4mm)             |
|     | 155-1-062                    | H.D. Contact Tip, .062" (1.6mm)             |
|     | 155-1-564                    | H.D. Contact Tip, 5/64" (2.0mm)             |
|     | 155-1-332                    | H.D. Contact Tip, 3/32" (2.4mm)             |
| 3.  | 155-2-030                    | H.D. Tapered Contact Tip, .030" (0.8mm)     |
|     | 155-2-035                    | H.D. Tapered Contact Tip, .035" (0.9mm)     |
|     | 155-2-040                    | H.D. Tapered Contact Tip, .040" (1.0mm)     |
|     | 155-2-045                    | H.D. Tapered Contact Tip, .045" (1.2mm)     |
|     | 155-2-364                    | H.D. Tapered Contact Tip, 3/64" (1.2mm)     |
|     | 155-2-052                    | H.D. Tapered Contact Tip, .052" (1.4mm)     |
|     | 155-2-062                    | H.D. Tapered Contact Tip, .062" (1.6mm)     |
| 4.  | 154-R505                     | Diffuser H.D., for CM Taper-LOCK Tip        |
| 5.  | 154-1                        | Replacement Retaining Ring                  |
| 6.  | 154-2                        | Replacement O-Ring                          |
| 7.  | 154-R506                     | Diffuser, for CM Taper-LOCK Tip             |
| 8.  | 154-1                        | Replacement Retaining Ring                  |
| 9.  | 154-2                        | Replacement O-Ring                          |
| 10. | R402-11                      | Neck Insulator                              |
| 11. | R505-45                      | Neck w/ Body, 45°                           |
|     | R505-60                      | Neck w/ Body, 60°                           |
|     | R505-180                     | Neck w/ Body, 180°                          |
| 12. | R407                         | Replacement Body                            |
| 13. | R407-2                       | Body Screw                                  |

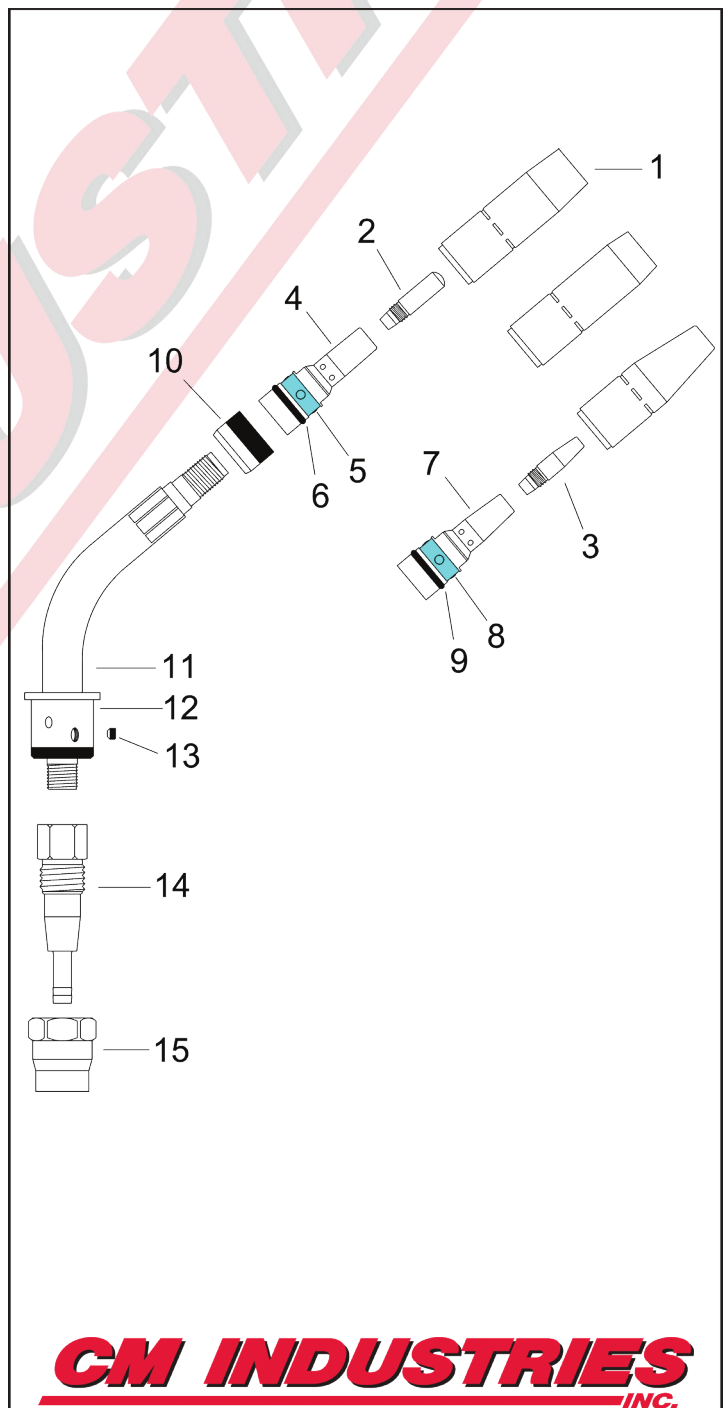

**CM INDUSTRIES**  
INC.

| #   | Part Number | Description                                   |
|-----|-------------|---|
| 14. | R408        | Connector Cone                                |
| 15. | R509        | Cone Nut                                      |
| 16. | R413-5      | Inner Tube Clamp                              |
| 17. | R412-1      | Switch Lead Connector                         |
| 18. | R413-1      | Outer Jacket Clamp                            |
| 19. | R411-3      | Mounting Screw                                |
| 20. | R411-2      | Switch Housing                                |
| 21. | R411-1      | Switch  |
| 22. | R410        | Handle, Front                                 |
| 23. | R513-2      | Spring Guard, Front                           |
| 24. | R513-10     | Unicable Assembly, 10'                        |
|     | R513-12     | Unicable Assembly, 12'                        |
|     | R513-15     | Unicable Assembly, 15'                        |
|     | R513-20     | Unicable Assembly, 20'                        |
|     | R513-25     | Unicable Assembly, 25'                        |
| 25. | B2520041-S  | Strain Relief Spring                          |
| 26. | B2520066    | Strain Relief Kit                             |
| 27. | R414-400CM  | Power Pin Block                               |
| 28. | R214        | Power Pin, Tweco                              |
| 29. | R414-1      | O-Ring  |
| 30. | C44C        | Liner Set Screw                               |
| 31. | R214-1      | Power Pin, Miller                             |
| 32. | R414-11-2   | O-Ring, Miller                                |
| 33. | R214-116    | Guide Cap, Miller .035"-1/16" Wire            |
| 34. | R214-2      | Power Pin, Lincoln "LN"                       |
| 35. | 401-00-001  | Adaptor Nut                                   |
| 36. | 285-03-002  | Male Pin w/ Lead                              |
| 37. | R425-10CM   | Power Pin, Euro                               |
| 38. | 285-00-002  | O-Ring, Euro                                  |
| 39. | 300-05-001  | Electrical Plug, Miller                       |
| 40. | 300-05-002  | Electrical Plug, Lincoln                      |
| 41. | R415-30-15  | Liner Assembly, .030", 15'                    |
|     | R415-35-15  | Liner Assembly .035"-.045", 15'               |
|     | R415-116-15 | Liner Assembly .045"-1/16", 15'               |
|     | R415-564-15 | Liner Assembly, 1/16-5/64", 15'               |
|     | R415-332-15 | Liner Assembly, 5/64-3/32", 15'               |
|     | R415-35-2   | Liner Assembly .035"-3/64", 15' Aluminum      |
|     | R415-116-2  | Liner Assembly 3/64"-1/16", 15' Aluminum      |
|     | R415-35-0   | Teflon Liner Assy., .035"-3/64", 15' Aluminum |
|     | R415-116-0  | Teflon Liner Assy., 3/64"-1/16", 15' Aluminum |
|     | R415-35-25  | Liner Assembly .035"-.045", 25'               |
|     | R415-116-25 | Liner Assembly .045"-1/16", 25'               |
|     | R415-564-25 | Liner Assembly, 1/16-5/64", 25'               |
|     | R415-332-25 | Liner Assembly, 5/64-3/32", 25'               |

