

# **CM INDUSTRIES** **INC.**

## **Water Cooler WC3500**



### ***Operating Manual and Parts List***

MODEL	PART#	BTU/HOURS	GALLONS	LITER	VOLTS	AMPS	HZ
WC3500	690-25-100	15,000	2.5	11.4	115	5.0	50/60
WC3500	690-25-102	15,000	2.5	11.4	230	2.5	50/60

MADE IN USA

**DO NOT INSTALL, OPERATE, OR REPAIR THIS EQUIPMENT  
WITHOUT READING THIS OPERATING MANUAL**

**CM INDUSTRIES**  
**INC.**

July 2017

505 Oakwood Rd. Lake Zurich, IL 60047  
ph: 847-550-0033 fx: 847-550-0444  
email: [sales@cmindustries.com](mailto:sales@cmindustries.com)  
[www.cmindustries.com](http://www.cmindustries.com)

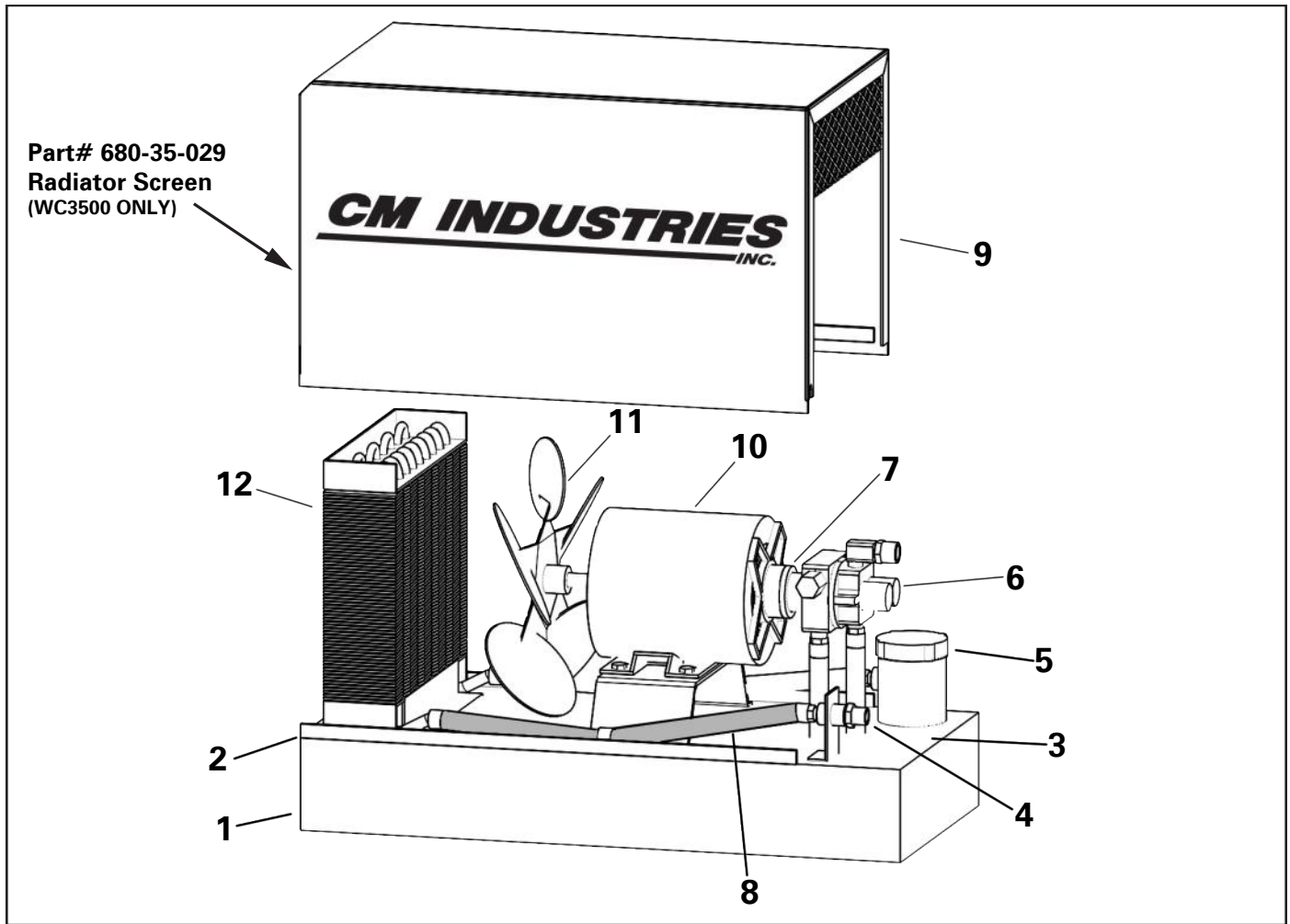

## WC3500 - 3 GL STAINLESS STEEL WATER COOLER

### Specifications:

#### Dimensions:

23" Long x 11" Wide x 14 3/4" High  
(58.4 cm x 27.9 cm x 37.5 cm)

#### Reservoir:

3 Gallon Capacity

#### Pump Capacity:

100 psi max. 1.5 gpm (5.68 lpm) @ 50 psi.  
1.8 gpm (6.81 lpm) @ 60 psi.

#### Motor Voltage:

115V or 230VAC, Single Phase, 50/60 Hz

#### Amperage:

5.0/6.8, 2.5/3.4

#### Heat Exchanger:

High Efficiency, Copper Core, Rustproof, 15,000 BTU

#	PART #	DESCRIPTION
1	680-35-020	Tank
2	680-35-021	Tank Gasket
3	680-35-022	Tank Cover Plate
4	680-30-023	Inert Gas Adapter
5	680-30-024	Sight Glass Assembly
6	680-30-067	Pump, Rotary Vane
6a	680-30-069	Pump Screen
7	680-30-068	Clamp, Pump to Motor
8	680-35-025	Rubber Hose
9	680-35-026	Hood
10	680-30-061	Motor 115/230V 50/60Hz
11	680-35-027	Fan, 10"
12	680-35-028	Radiator

#### Water Connections:

5/8"-18 UNC Left-Handed Inert Gas Fittings

#### Net Weight:

43 lbs. (19.5 kg)

#### Approximate Shipping Weight:

45 lbs. (20.5 kg)