

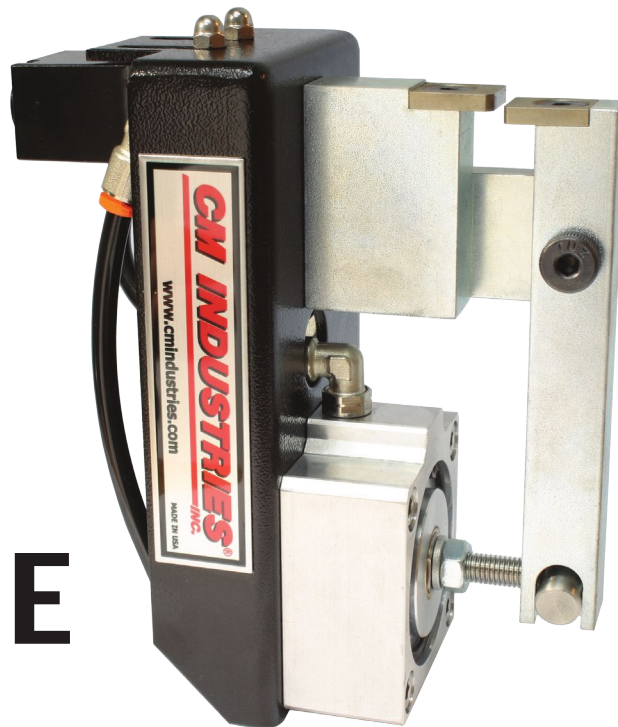

KOOL RUN™

Driven by Performance



WC-95E

Electronically Controlled Wire-Cutter

Operating Manual and Parts List

**DO NOT INSTALL, OPERATE, OR REPAIR THIS EQUIPMENT
WITHOUT READING THIS OPERATING MANUAL**

MADE IN USA

CM INDUSTRIES
INC.

January 2016

505 Oakwood Rd. Lake Zurich, IL 60047
ph: 847-550-0033 fx: 847-550-0444
email: sales@cmindustries.com
www.cmindustries.com

WC-95E Pneumatic Wire Cutter

The CMI Wire Cutter removes the ball end of the welding wire for consistent wire stick-out, providing smooth arc starts.

The Wire Cutter can be easily mounted to a remote location or directly to our Nozzle Cleaning Station and can be used with all makes and models of robotic equipment.

Technical Specifications

AIR REQUIREMENT: 80-120 psi Clean Shop Air

CUTTING RANGE: Up to 1/8" (3.2mm)

MOUNTING: Hole Spacing 2-7/16"

WC-95E Wire Cutter w/ Electronic Valve

Hookup & Operation:

1. Mount the wire cutter directly to the 2100 series Nozzle Cleaning Station or any remote location.
2. Provide an air supply, 80-120 psi, to the air inlet on the activator valve (item 2).
3. Program the robot nozzle / welding wire to pass between the cutter blades (item 5).
4. Program the robot to activate the ground "ON" (Line 1) for a cycle time of 0.5 seconds.

Connect lines to Brown and Blue on Terminal Strip.

NOTE: Electrical lines connected to Terminal Strip shown:

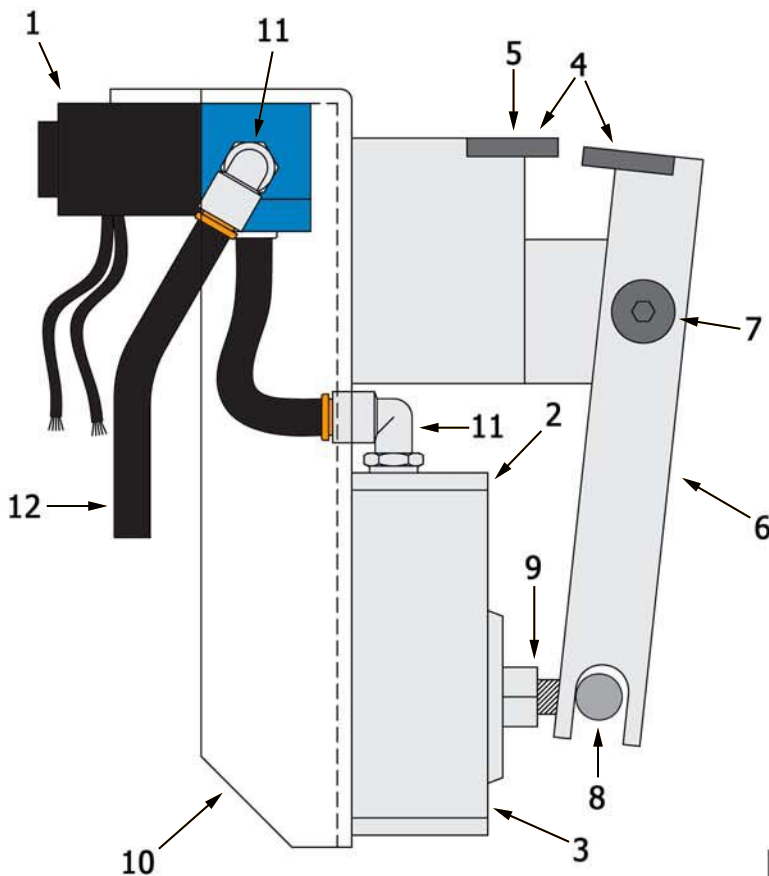
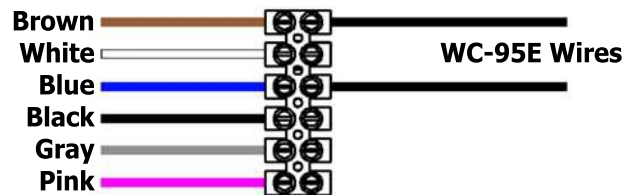

#	PART #	DESCRIPTION
1	650-25-420	Electronic Valve
2	650-25-006	Cylinder
3	650-25-010	Screw for Cylinder
4	650-25-028	Cutter Blade
5	650-25-030	Screw, Cutter Blade
6	650-25-034	Arm Assembly
7	650-25-035	Shoulder Bolt
8	650-25-036	Pivot
9	650-25-037	Stud w/ Nut
10	650-25-038	Bracket
11	650-25-738	Male Elbow 1/8" - 1/4" Push
12	650-25-279	Tubing, 1/4" O.D.



WARNING

Read and follow the manufacturer's instructions, employer's safety practices, and Material Safety Data Sheets (MSDSs).

Only qualified personnel should install, use, or service this material and/or equipment.



WELDING SPARKS can cause fire or explosion

- Do not weld near flammable material
 - Do not weld on closed containers.
 - Remove combustibles from the work area and/or provide a fire watch.
 - Avoid oily or greasy clothing as a spark may ignite them.
-



ARC RAYS can injure eyes and burn skin

- Always wear correct eye, ear, and body protection
 - Always wear a welding helmet with the proper grade filter lens. Protect yourself and others from spatter arc flash rays by using protective screens, barriers and welding curtains.
 - Always wear protective gloves and clothing to cover exposed skin. This will aid in the prevention of arc and spatter burns.
-



ELECTRIC SHOCK can kill.

- Always wear dry installing gloves
 - Do not touch live electrical parts.
 - Always disconnect power source before hooking up or changing electrodes, nozzles and other parts.
-



FUMES AND GASES can be hazardous to your health.

- Keep your head out of the fumes
 - Use enough ventilation or exhaust at the arc to keep fumes and gases from your breathing zone, and general area.
 - Fumes from cutting and welding can deplete air quality, causing injury or death. Always wear an air supplied respirator in confined areas, or if breathing air is not safe.
-



LOUD NOISE can damage hearing.

- Always wear protective hearing devices to ensure protection when noise levels exceed OSHA standards
-

CALIFORNIA PROPOSITION 65 WARNING

This product contains chemicals, including lead, known to the State of California to cause cancer, birth defects, or other reproductive harm. Wash hands after use.

(California Health & Safety Code Section 25249.5)