

MIL M40

AIR-COOLED MIG GUN

Replacement Suitable for Miller®

RATING	GUN ORDERING PART NUMBER		POWER PIN Direct Connect
400 Amp CO2 @ 100% Duty Cycle 400 Amp Mixed Gas @ 60% Duty Cycle Wire Capacity: 0.023" (0.6mm) - 5/64" (2.0mm)	M169-602	10', .035"-.045" Liner	Miller®
	M169-604	12', .035"-.045" Liner	Miller®
	M169-606	15', .035"-.045" Liner	Miller®
	M169-606-20	20', .035"-.045" Liner	Miller®
	M169-606-25	25', .035"-.045" Liner	Miller®
Direct Plugs available for Euro, Hobart®, Lincoln® "LN", Lincoln® Power MIG™, and Tweco®.			

#	Part Number	Description
1.	M200-258 M169-724 M169-725 M169-726 M169-727 M176-243	Nozzle 1/2", Flush Tip Nozzle 1/2", Recess 1/8" Nozzle 5/8", Recess 1/8", Std. Nozzle 5/8", Flush Tip Nozzle 5/8", Stickout 1/8" Nozzle 3/8", Tapered
2.	M087-299 M000-067 M000-068 M172-034 M000-069 M044-392 M172-024 M172-025	Contact Tip, .023" 0.6mm Contact Tip, .030" 0.8mm Contact Tip, .035" 0.9mm Contact Tip, 3/64" 1.19mm Contact Tip, .045" 1.2mm, Std. Contact Tip, .052" 1.4mm Contact Tip, 1/16" 1.6mm Contact Tip, 5/64" 2.0mm
3.	M176-797 M176-793 M176-794	Contact Tip, Tapered, .030" 0.8mm Contact Tip, Tapered, .035" 0.9mm Contact Tip, Tapered, .045" 1.2mm
4.	M169-728	Tip Adaptor
5.	M169-729 M170-467 M170-468	Nozzle Retainer Repl. Retaining Ring Repl. O-Ring
6.	M169-730	Shock Washer
7.	M169-744	Conductor Tube Assembly
8.	M170-453	Body
9.	M602-177	Repl. Body Screw
10.	M170-452	Connector Cone
11.	M170-451	Cone Nut

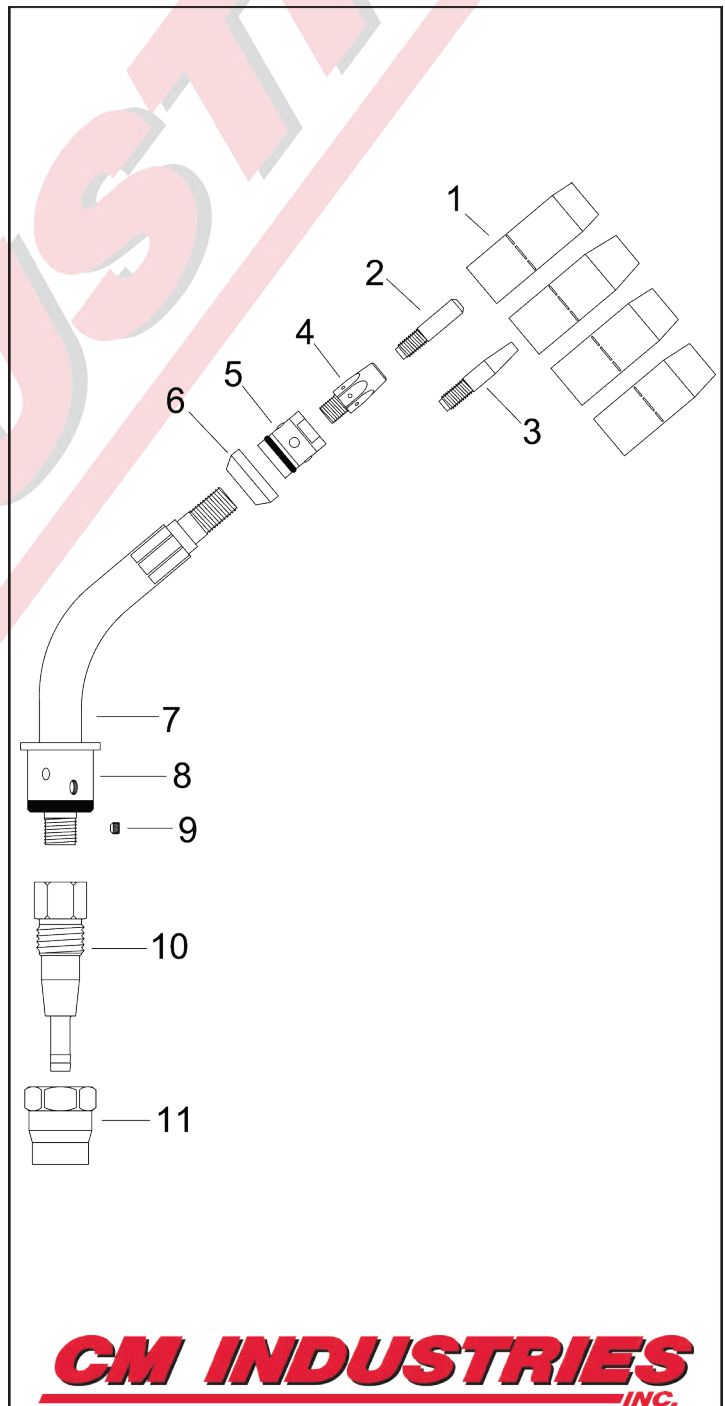

CM INDUSTRIES
INC.

#	Part Number	Description
12.	M170-460	Inner Tube Clamp
13.	M169-746	Switch Lead Connector
14.	M170-457	Outer Jacket Clamp
15.	R411-3	Mounting Screw
16.	M170-456	Switch Housing
17.	M170-455	Switch
18.	M170-454	Handle, Front & Rear
19.	M170-458	Spring Guard, Front & Rear
20.	M400-10	Unicable Assembly w/ Handles, 10'
	M400-12	Unicable Assembly w/ Handles, 12'
	M400-15	Unicable Assembly w/ Handles, 15'
	M400-20	Unicable Assembly w/ Handles, 20'
	M400-25	Unicable Assembly w/ Handles, 25'
21.	R416-5	Control Housing
22.	M169-745	Miller Power Pin
23.	M079-974	O-Ring, Miller
24.	M169-723	Guide Cap, Miller .035"-1/16" Wire
25.	300-05-001	Electrical Plug, Miller
26.	M194-010	Liner Assembly, 15', .023"-.025"
	M194-011	Liner Assembly, 15', .030"-.035"
	M194-011-25	Liner Assembly, 25', .030"-.035"
	M194-012	Liner Assembly, 15', .035"-.045", Std.
	M194-012-25	Liner Assembly, 25', .035"-.045"
	M194-013	Liner Assembly, 15', 1/16"-5/64"
	M194-014	Liner Assembly, 15', .035"-3/64", Aluminum
27.	M079-975	Liner O-Ring

