

# BND 500AUTO AIR-COOLED MIG GUN

Replacement Suitable for Bernard®

RATING	GUN ORDERING PART NUMBER	POWER PIN Direct Connect
<b>500 AMP CO2 @ 100% Duty Cycle</b>  <b>375 Amp Mixed Gas @ 100% Duty Cycle</b>  <b>Wire Capacity: 0.035" (0.9mm) - 7/64" (2.8mm)</b>	BAUT5xx7EBC BAUT5xx7EEC BAUT5xx7EHC BAUT5xx7ELC BAUT5xx7ESC BAUT5xx7EMC BAUT5xx7ETC BAUT5xx7EWC	Bernard® Euro Hobart® Lincoln® "LN" Lincoln® "LF" Miller® Tweco® #4 Tweco® #5
	xx = Standard lengths of 4, 6, 8, and 10 ft. Custom lengths also available.	

#	Part Number	Description
1.	B4591 B4591HD	Nozzle - Copper 3/4" I.D. Nozzle - Copper, Heavy Duty 3/4" I.D.
2.	B4592 B4592HD	Nozzle - Copper 9/16" I.D. Nozzle - Copper, Heavy Duty 9/16" I.D.
3.	B7489 B7496 B7490 B7498 B7491 B7492 B7493 B7494	Contact Tip, .035" 0.9mm Contact Tip, .040" 1.0mm Contact Tip, .045" 1.2mm Contact Tip, .052" 1.4mm Contact Tip, 1/16" 1.6mm Contact Tip, 5/64" 2.0mm Contact Tip, 3/32" 2.4mm Contact Tip, 7/64" 2.8mm
	B1589 B1596 B1590 B1598 B1591 B1592 B1593 B1594	Contact Tip, Long, .035" 0.9mm Contact Tip, Long, .040" 1.0mm Contact Tip, Long, .045" 1.2mm Contact Tip, Long, .052" 1.4mm Contact Tip, Long, 1/16" 1.6mm Contact Tip, Long, 5/64" 2.0mm Contact Tip, Long, 3/32" 2.4mm Contact Tip, Long, 7/64" 2.8mm
	<b>CMI "Taper-LOCK" Contact Tips</b>	
4.	155-1-030 155-1-035 155-1-040 155-1-045 155-1-364 155-1-052 155-1-062 155-1-564 155-1-332	H.D. Contact Tip, .030" (0.8mm) H.D. Contact Tip, .035" (0.9mm) H.D. Contact Tip, .040" (1.0mm) H.D. Contact Tip, .045" (1.2mm) H.D. Contact Tip, 3/64" (1.2mm) H.D. Contact Tip, .052" (1.4mm) H.D. Contact Tip, .062" (1.6mm) H.D. Contact Tip, 5/64" (2.0mm) H.D. Contact Tip, 3/32" (2.4mm)
	155-2-030 155-2-035 155-2-040 155-2-045 155-2-364 155-2-052 155-2-062	H.D. Tapered Contact Tip, .030" (0.8mm) H.D. Tapered Contact Tip, .035" (0.9mm) H.D. Tapered Contact Tip, .040" (1.0mm) H.D. Tapered Contact Tip, .045" (1.2mm) H.D. Tapered Contact Tip, 3/64" (1.2mm) H.D. Tapered Contact Tip, .052" (1.4mm) H.D. Tapered Contact Tip, .062" (1.6mm)
5.	B4435 B4435-116 B4635 B4635-116	Head Assembly Head Assembly w/ Tube Head Assembly, for Long Contact Tip Head Assembly w/ Tube
6.	B4435 -TL18	Head Assembly, for Taper-LOCKTM Tip
7.	B4423R	Silicone Cap
8.	B500-180	Body Tube AUTO 180°
9.	B408AUT	Handle Kit, Auto
10.	B608P	Handle Screw, M4 Nylon

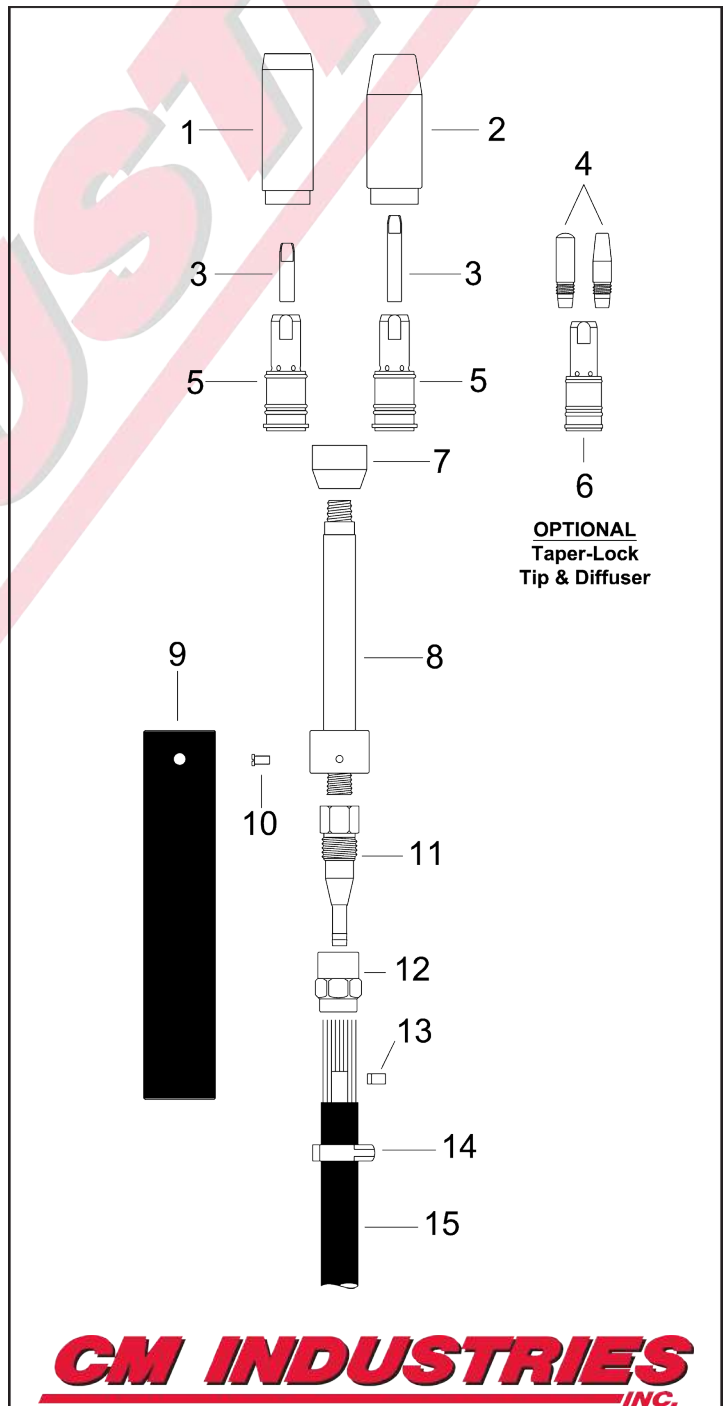

**CM INDUSTRIES**  
INC.

#	Part Number	Description
11.	B4513T	End Fitting
12.	B4416	Cone Nut
13.	B4993	Clamp, Conduit
14.	B4944	Clamp, Jacket
15.	B1060124	500A Cable Assembly, 4'
	B1060125	500A Cable Assembly, 6'
	B1060126	500A Cable Assembly, 8'
	B1060127	500A Cable Assembly, 10'
16.	B2520041	Strain Relief Spring
17.	B2520066	Strain Relief Kit
18.	B2280056	Screw
19.	B1010027R	Adaptor Block
20.	R214-1	Power Pin w/ O-Rings, Miller
21.	R214-116	Power Pin Tip, Miller .035" - 1/16"
22.	R414-11-2	O-Ring, Miller
23.	R214	Power Pin w/ O-Rings, Tweco 4
24.	R414-1	O-Ring, Tweco 4
25.	B214-2	Power Pin, Lincoln "LN"
26.	B4816	Euro Connector Nut
27.	B5060CM	Euro Connector Plug
28.	B4421	O-Ring, Euro
29.	B2520041	Strain Relief Spring
30.	B1880074	Rigid Strain Relief Kit
31.	B4207	Post Fastener
32.	B4209	Handle Screw
33.	B4925	Locking Sleeve
34.	B4901	Quick Connect Body
35.	B4924	Lead Wire
36.	B4919	Gas Pin Assembly
37.	B4916	Wave Spring
38.	B4912	Snap Ring, Small
39.	B4911	Snap Ring, Large
40.	B2200140	Power Pin, Bernard EZ
	B1880259B	Bernard Quick Disconnect Kit (34-40)
41.	L1A-15	Liner Assembly, 15', .023"-.030"
	L2A-15	Liner Assembly, 15', .030"-.035"
	L3A-15	Liner Assembly, 15', .035"-.045"
	L4A-15	Liner Assembly, 15', .045"- 1/16"
	L6A-15	Liner Assembly, 15', 5/64"
	L7A-15	Liner Assembly, 15', 3/32"
	L8A-15	Liner Assembly, 15', 7/64"

Liners are also available in 25' lengths

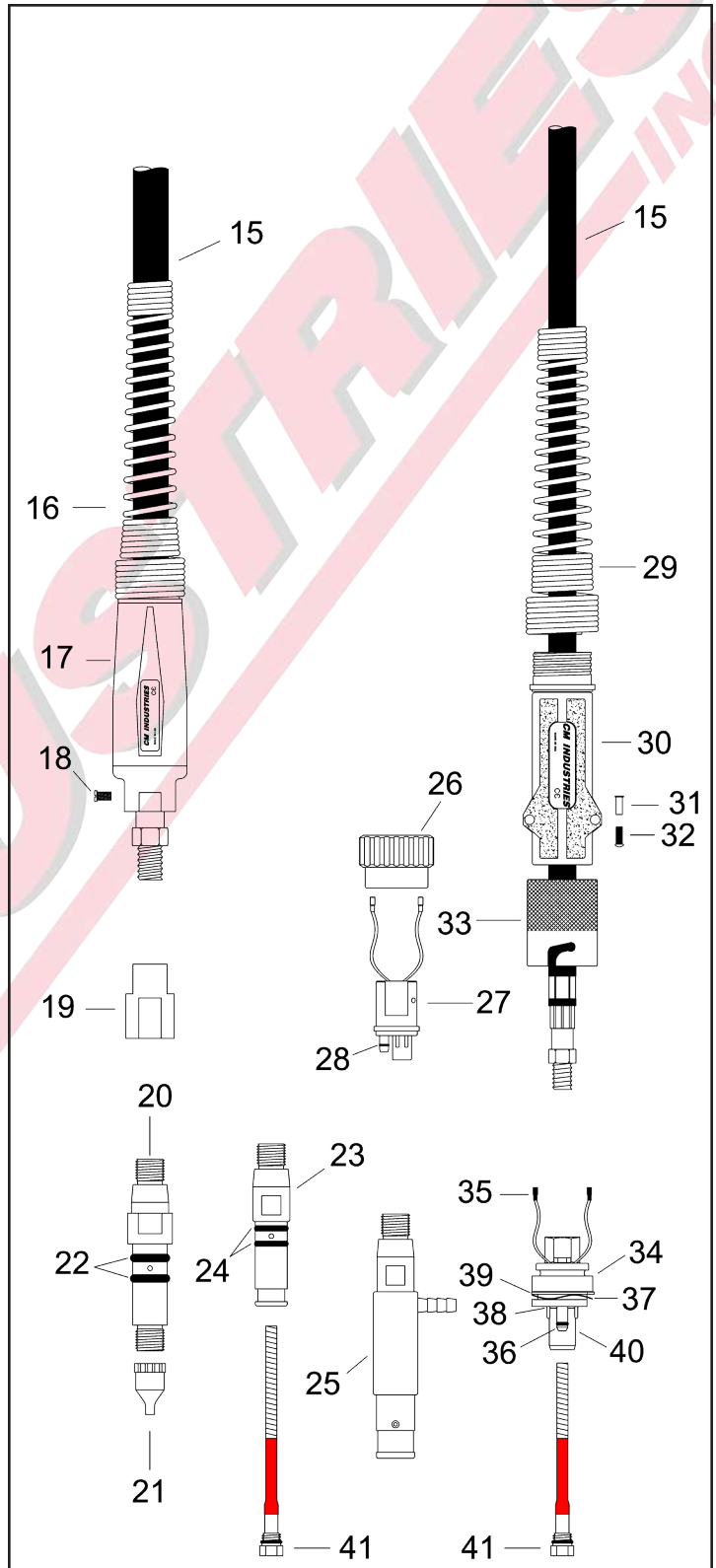

# WARNING!

## Please Read All Safety Instructions



# WARNING

- Read and follow the manufacturer's instructions, employer's safety practices, and Material Safety Data Sheets (MSDSs).
- Only qualified personnel should install, use, or service this material and/or equipment.



### **ELECTRIC SHOCK can kill.**

- Always wear dry installing gloves.
- Do not touch live electrical parts.
- Always disconnect power source before hooking up or changing electrodes, nozzles and other parts.



### **WELDING SPARKS can cause fire or explosion**

- Do not weld near flammable material.
- Do not weld on closed containers.
- Remove combustibles from the work area and/or provide a fire watch.
- Avoid oily or greasy clothing as a spark may ignite them.



### **LOUD NOISE can damage hearing.**

- Always wear protective hearing devices to ensure protection when noise levels exceed OSHA standards.



### **ARC RAYS can injure eyes and burn skin.**

- Always wear correct eye, ear, and body protection.
- Always wear a welding helmet with the proper grade filter lens. Protect yourself and others from spatter arc rays by using protective screens, barriers and welding curtains.
- Always wear protective gloves and clothing to cover exposed skin. This will aid in the prevention of arc and spatter burns.



### **FUMES AND GASES can be hazardous to your health.**

- Keep your head out of the fumes.
- Use enough ventilation or exhaust at the arc to keep fumes and gases from your breathing zone, and general area.
- Fumes from cutting and welding can deplete air quality, causing injury or death. Always wear an air supplied respirator in confined areas, or if breathing air is not safe.

Read America Nation Standard Z49.1, "Safety in Welding, Cutting, and Allied Processes," available from America Welding Society, 550 N.W. LeJeune Rd., Miami, FL 33126;

OSHA Safety and health standards, available from U.S. Government Printing Office, Washington DC 20402

## **CM INDUSTRIES**

**INC.**

505 OAKWOOD ROAD LAKE ZURICH, IL 60047

PH: 847-550-0033 FX: 847-550-0444

[www.cmindustries.com](http://www.cmindustries.com)