

BND 300

AIR-COOLED MIG GUN

Replacement Suitable for Bernard®

RATING	GUN ORDERING PART NUMBER	POWER PIN Direct Connect
300 AMP CO2 @ 100% Duty Cycle 250 Amp Mixed Gas @ 100% Duty Cycle Wire Capacity: 0.023" (0.6mm) - 1/16" (1.6mm)	BQ30xxAE7CBC BQ30xxAE7CEC BQ30xxAE7CHC BQ30xxAE7CLC BQ30xxAE7CSC BQ30xxAE7CUC BQ30xxAE7CMC BQ30xxAE7CTC	Bernard® Euro Hobart® Lincoln® "LN" Lincoln® "LF" Lincoln® Power MIG™ Miller® Tweco®
xx = Standard lengths of 10, 12, 15, 20, and 25 ft. Custom lengths also available.		

#	Part Number	Description
1.	B4391 B4393 B4392 B4394 B4295	Nozzle - Brass 5/8" I.D. Nozzle - Copper 5/8" I.D. Nozzle - Brass 1/2" I.D. Nozzle - Copper 1/2" I.D. Nozzle - Brass Tapered, Long - 11/32" I.D.
2.	B7497 B7488 B7489 B7496 B7490 B7498 B7491 B1597 B1588 B1589 B1596 B1590 B1598 B1591 B4285 B4281 B4299 B4282 B4283 B4280	Contact Tip, .023" (0.6mm) Contact Tip, .030" (0.8mm) Contact Tip, .035" (0.9mm) Contact Tip, .040" (1.0mm) Contact Tip, .045" (1.2mm) Contact Tip, .052" (1.4mm) Contact Tip, 1/16" (1.6mm) Contact Tip, Long, .023" (0.6mm) Contact Tip, Long, .030" (0.8mm) Contact Tip, Long, .035" (0.9mm) Contact Tip, Long, .040" (1.0mm) Contact Tip, Long, .045" (1.2mm) Contact Tip, Long, .052" (1.4mm) Contact Tip, Long, 1/16" (1.6mm) Contact Tip, Tapered, .035" (0.8mm) Contact Tip, Tapered, .035" (0.9mm) Contact Tip, Tapered, .040" (1.0mm) Contact Tip, Tapered, .045" (1.2mm) Contact Tip, Tapered, .052" (1.4mm) Contact Tip, Tapered, 1/16" (1.6mm)
2a.	CMI "Taper-LOCK" Contact Tips 155-1-030 155-1-035 155-1-040 155-1-045 155-1-364 155-1-052 155-1-062 155-2-030 155-2-035 155-2-040 155-2-045 155-2-364 155-2-052 155-2-062	H.D. Contact Tip, .030" (0.8mm) H.D. Contact Tip, .035" (0.9mm) H.D. Contact Tip, .040" (1.0mm) H.D. Contact Tip, .045" (1.2mm) H.D. Contact Tip, 3/64" (1.2mm) H.D. Contact Tip, .052" (1.4mm) H.D. Contact Tip, .062" (1.6mm) H.D. Tapered Contact Tip, .030" (0.8mm) H.D. Tapered Contact Tip, .035" (0.9mm) H.D. Tapered Contact Tip, .040" (1.0mm) H.D. Tapered Contact Tip, .045" (1.2mm) H.D. Tapered Contact Tip, 3/64" (1.2mm) H.D. Tapered Contact Tip, .052" (1.4mm) H.D. Tapered Contact Tip, .062" (1.6mm)
2b.	B4335-TL18	Head Assembly, for Taper-LOCK Tip
3.	B4335 B4335-116	Head Assembly Head Assembly w/ Tube
4.	B4235 B4235-116	Head Assy., for Long Contact Tip Head Assembly w/ Tube

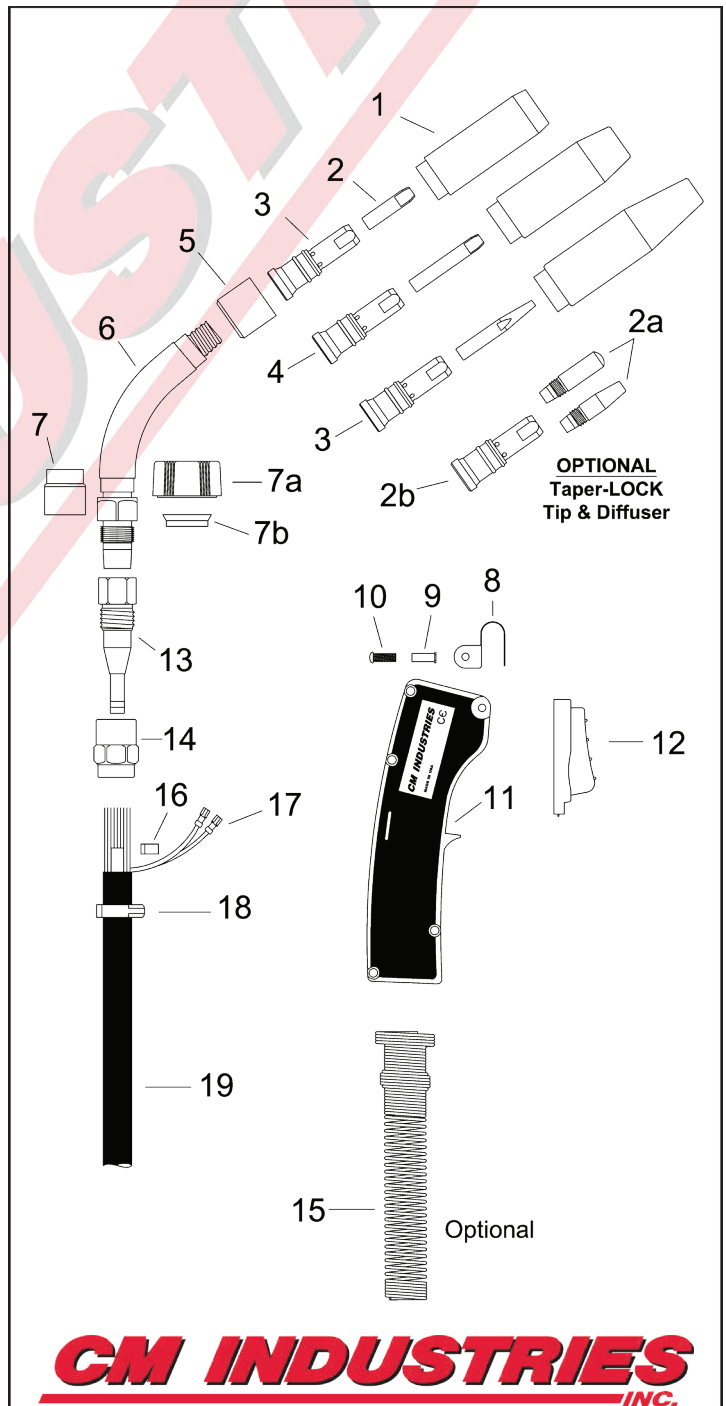

CM INDUSTRIES
INC.

#	Part Number	Description
5.	B4323R	Silicone Cap
6.	BQT3-30	Body Tube, Medium 30°
	BQT3-45	Body Tube, Medium 45°
	BQT3-60	Body Tube, Medium 60°
	BQT3-80	Body Tube, Medium 80°
7.	B4780	Insulator Hex Nut
7a.	B1840057	Plastic Lock Nut
7b.	B1840031	Silicone Rubber Seal
8.	B4238	Hang Up Hook
9.	B4207	Post Fastener
10.	B4209	Handle Screw
	B1880004	Screw/Post Kit
11.	B1880155	Handle Kit w/ Screws
12.	B5662	Trigger Assembly
13.	B4313B	End Fitting
14.	B4305	Cone Nut
15.	B2520074	Handle Spring - Optional
16.	B4991	Clamp, Conduit
17.	B2660001	Trigger Terminal
18.	B7669	Clamp, Jacket
19.	B1060109	300A Cable Assembly, 10'
	B1060110	300A Cable Assembly, 12'
	B1060111	300A Cable Assembly, 15'
	B1060112	300A Cable Assembly, 20'
	B1060113	300A Cable Assembly, 25'
20.	B2520041-S	Strain Relief Spring
21.	B2520066	Strain Relief Kit
22.	B2280056	Screw
23.	BGN2021	Electrical Plug, Miller
24.	B4719	Electrical Plug, Lincoln
25.	B1010027R	Adaptor Block
26.	R214-1	Power Pin w/ O-Rings, Miller
27.	R214-116	Power Pin Tip, Miller .035" - 1/16"
28.	R414-11-2	O-Ring, Miller
29.	R214	Power Pin w/ O-Rings, Tweco 4
30.	R414-1	O-Ring, Tweco 4
31.	C44C	Set Screw
32.	B214-2	Power Pin, Lincoln "LN"
33.	B4816	Euro Connector Nut
34.	B5060CM	Euro Connector Plug
35.	B4421	O-Ring, Euro
36.	B2520041-S	Strain Relief Spring
37.	B1880074	Rigid Strain Relief Kit
38.	B4925	Locking Sleeve
39.	B4901	Quick Connect Body
40.	B4924	Lead Wire
41.	B4919	Gas Pin Assembly
42.	B4916	Wave Spring
43.	B4912	Snap Ring, Small
44.	B4911	Snap Ring, Large
45.	B2200140	Power Pin, Bernard EZ
	B1880259B	Bernard Quick Disconnect Kit (38-45)
46.	L1A-15	Liner Assembly, 15', .023"-.030"
	L2A-15	Liner Assembly, 15', .030"-.035"
	L3A-15	Liner Assembly, 15', .035"-.045"
	L4A-15	Liner Assembly, 15', .045"- 1/16"

Liners are also available in 25' lengths

