

BND 200

AIR-COOLED MIG GUN

Replacement Suitable for Bernard®

RATING	GUN ORDERING PART NUMBER	POWER PIN Direct Connect
200 AMP CO2 @ 100% Duty Cycle 150 Amp Mixed Gas @ 100% Duty Cycle Wire Capacity: 0.023" (0.6mm) - 0.045" (1.2mm)	BQ20xxAB7CBC	Bernard®
	BQ20xxAB7CBC	Euro
	BQ20xxAB7CBC	Hobart®
	BQ20xxAB7CBC	Lincoln® "LN"
	BQ20xxAB7CBC	Lincoln® "LF"
	BQ20xxAB7CBC	Lincoln® Power MIG™
	BQ20xxAB7CBC	Miller®
	BQ20xxAB7CBC	Tweco®
xx = Standard lengths of 10, 12, 15, 20, and 25 ft. Custom lengths also available.		

#	Part Number	Description	
1.	B4391	Nozzle - Brass 5/8" I.D.	
	B4393	Nozzle - Copper 5/8" I.D.	
	B4392	Nozzle - Brass 1/2" I.D.	
	B4394	Nozzle - Copper 1/2" I.D.	
	B4295	Nozzle - Brass Tapered, Long - 11/32" I.D.	
2.	B7497	Contact Tip, .023" (0.6mm)	
	B7488	Contact Tip, .030" (0.8mm)	
	B7489	Contact Tip, .035" (0.9mm)	
	B7496	Contact Tip, .040" (1.0mm)	
	B7490	Contact Tip, .045" (1.2mm)	
	B1597	Contact Tip, Long, .023" (0.6mm)	
	B1588	Contact Tip, Long, .030" (0.8mm)	
	B1589	Contact Tip, Long, .035" (0.9mm)	
	B1596	Contact Tip, Long, .040" (1.0mm)	
	B1590	Contact Tip, Long, .045" (1.2mm)	
B4285	B4285	Contact Tip, Tapered, .030" (0.8mm)	
	B4281	Contact Tip, Tapered, .035" (0.9mm)	
	B4299	Contact Tip, Tapered, .040" (1.0mm)	
	B4282	Contact Tip, Tapered, .045" (1.2mm)	
	CMI "Taper-LOCK" Contact Tips		
2a.	155-1-030	H.D. Contact Tip, .030" (0.8mm)	
	155-1-035	H.D. Contact Tip, .035" (0.9mm)	
	155-1-040	H.D. Contact Tip, .040" (1.0mm)	
	155-1-045	H.D. Contact Tip, .045" (1.2mm)	
	155-1-364	H.D. Contact Tip, 3/64" (1.2mm)	
	155-2-030	H.D. Tapered Contact Tip, .030" (0.8mm)	
	155-2-035	H.D. Tapered Contact Tip, .035" (0.9mm)	
	155-2-040	H.D. Tapered Contact Tip, .040" (1.0mm)	
	155-2-045	H.D. Tapered Contact Tip, .045" (1.2mm)	
	155-2-364	H.D. Tapered Contact Tip, 3/64" (1.2mm)	
	2b.	B4335-TL18	Head Assembly, for Taper-LOCK™ Tip
	3.	B4335	Head Assembly
		B4335-116	Head Assembly w/ Tube
	4.	B4235	Head Assembly, for Long Contact Tip
B4235-116		Head Assembly w/ Tube	
5.	B4323R	Silicone Cap	
6.	BQT2-30	Body Tube, Short 30°	
	BQT2-45	Body Tube, Short 45°	
	BQT2-60	Body Tube, Short 60°	
	BQT2-80	Body Tube, Short 80°	
	BQT3-30	Body Tube, Medium 30°	
	BQT3-45	Body Tube, Medium 45°	
	BQT3-60	Body Tube, Medium 60°	
	BQT3-80	Body Tube, Medium 80°	

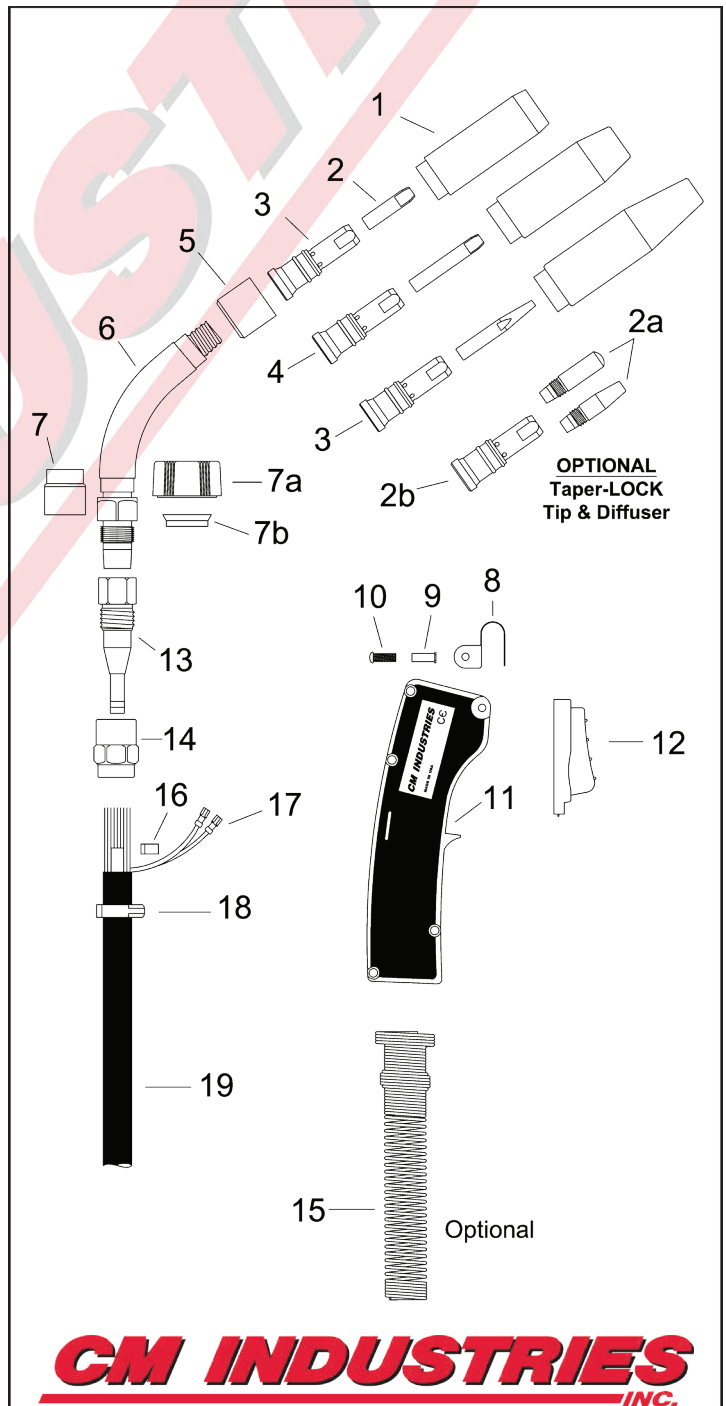

CM INDUSTRIES
INC.

#	Part Number	Description
7.	B4780	Insulator Hex Nut
7a.	B1840057	Plastic Lock Nut
7b.	B1840031	Silicone Rubber Seal
8.	B4238	Hang Up Hook
9.	B4207	Post Fastener
10.	B4209	Handle Screw
	B1880004	Screw/Post Kit
11.	B1880155	Handle Kit w/ Screws
12.	B5662	Trigger Assembly
13.	B4213B	End Fitting
14.	B4305	Cone Nut
15.	B2520074	Handle Spring - Optional
16.	B4991	Clamp, Conduit
17.	B2660001	Trigger Terminal
18.	B7669	Clamp, Jacket
19.	B1060121	200A Cable Assembly, 10'
	B1060122	200A Cable Assembly, 12'
	B1060123	200A Cable Assembly, 15'
	B1060124	200A Cable Assembly, 20'
	B1060125	200A Cable Assembly, 25'
20.	B2520041-S	Strain Relief Spring
21.	B2520066	Strain Relief Kit
22.	B2280056	Screw
23.	BGN2021	Electrical Plug, Miller
24.	B4719	Electrical Plug, Lincoln
25.	B1010027R	Adaptor Block
26.	R214-1	Power Pin w/ O-Rings, Miller
27.	R214-116	Power Pin Tip, Miller .035" - 1/16"
28.	R414-11-2	O-Ring, Miller
29.	R214	Power Pin w/ O-Rings, Tweco 4
30.	R414-1	O-Ring, Tweco 4
31.	C44C	Set Screw
32.	R214-2	Power Pin, Lincoln "LN"
33.	B4816	Euro Connector Nut
34.	B5060CM	Euro Connector Plug
35.	B4421	O-Ring, Euro
36.	B2520041-S	Strain Relief Spring
37.	B1880074	Rigid Strain Relief Kit
38.	B4925	Locking Sleeve
39.	B4901	Quick Connect Body
40.	B4924	Lead Wire
41.	B4919	Gas Pin Assembly
42.	B4916	Wave Spring
43.	B4912	Snap Ring, Small
44.	B4911	Snap Ring, Large
45.	B2200140	Power Pin, Bernard EZ
	B1880259B	Bernard Quick Disconnect Kit (38-45)
46.	L1A-15	Liner Assembly, 15', .023"-.030"
	L2A-15	Liner Assembly, 15', .030"-.035"
	L3A-15	Liner Assembly, 15', .035"-.045"
	L4A-15	Liner Assembly, 15', .045"- 1/16"

Liners are also available in 25' lengths

